

Residential construction system:

	SYSTEM 1	SYSTEM 2
floor slab	filigree type	filigree type
internal wall	2F	2F
external wall	2F/2FI	1- or 3-layer
balcony	filigree type	solid

The above elements can be used to compose bespoke construction systems.

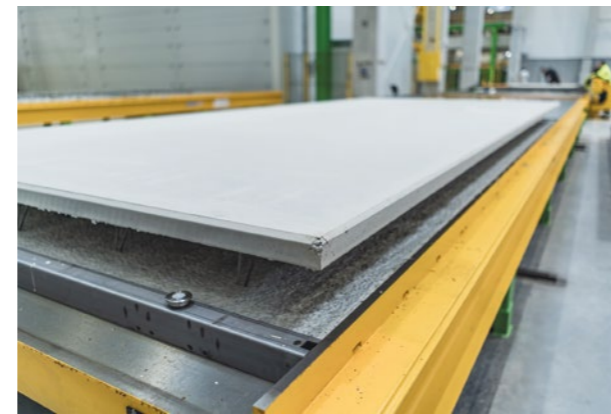

Pekabex

ul. Szarych Szeregów 27
60-462 Poznań, Poland

Phone: +48(61)821 0400
Fax.: +48(61)82211 42

oferty@pekabex.pl
www.pekabex.pl

MODULAR
CONSTRUCTION SYSTEM
PEKABEX

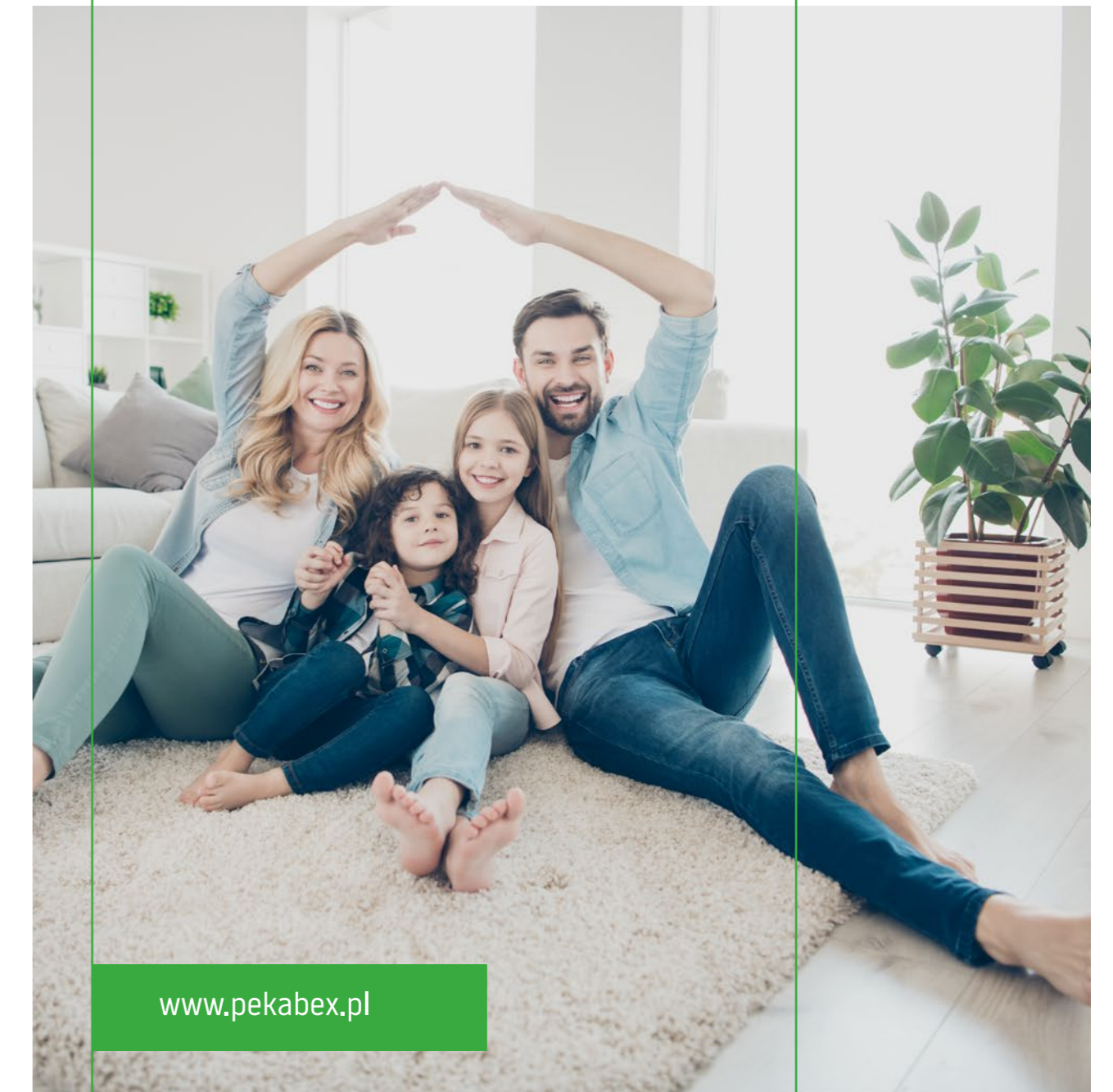

www.pekabex.pl

FILIGREE SLABS – ADVANTAGES

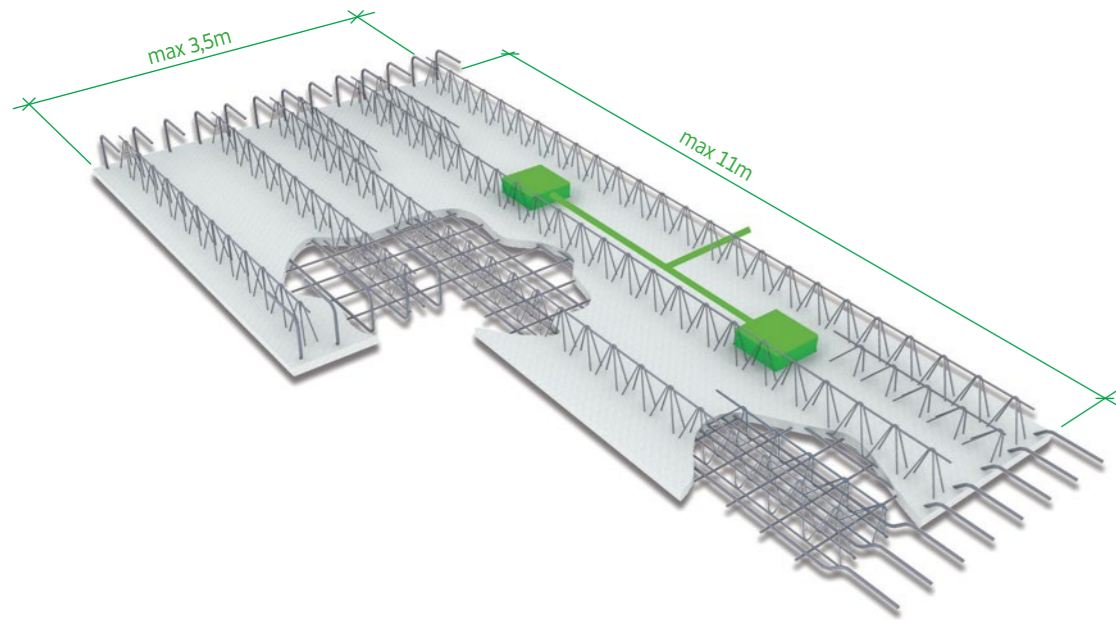

Advantages:

- suits any shape of the floor and panel design
- project specific (tailor-made) design
- reduced on-site floor construction time
- ceiling plastering not required
- no boarding or shuttering required for the floor slab (load bearing function combined with stay-in-place formwork)
- quick and easy installation
- lightweight panels
- high sound proofing of a complete assembly
- on-time completion, irrespective of weather conditions, precision
- high quality



TWIN WALLS

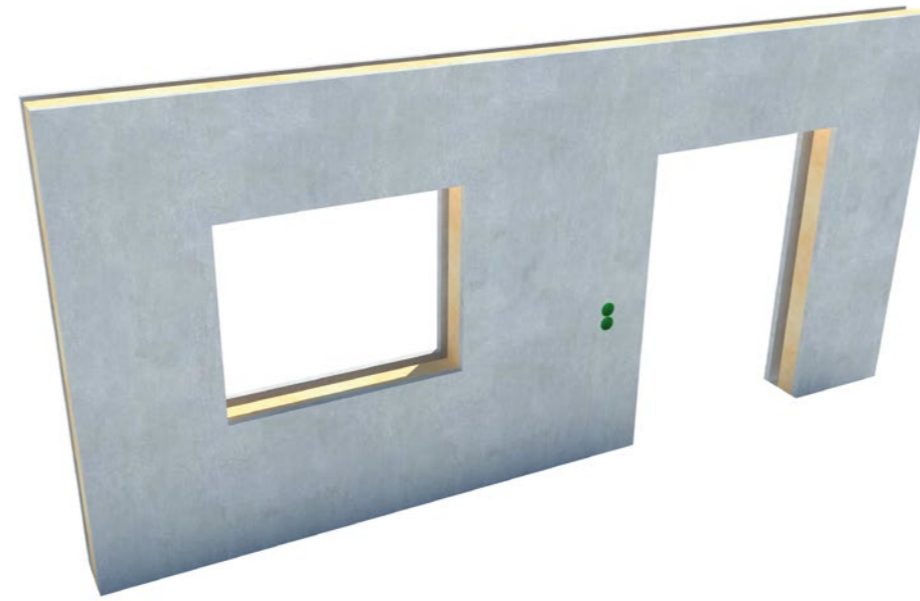

Range of application:

- turn-key residential construction
- heavy-duty soilconditions (excavations)
- infill construction (difficult or impossible shuttering)
- underground car parks
- cores of skeleton frame buildings
- tanks and silos
- civil engineering

panel thickness: **180-400mm**
partition thickness: **60mm**
max. panel length: **10m**
max. panel height: **3,6m**

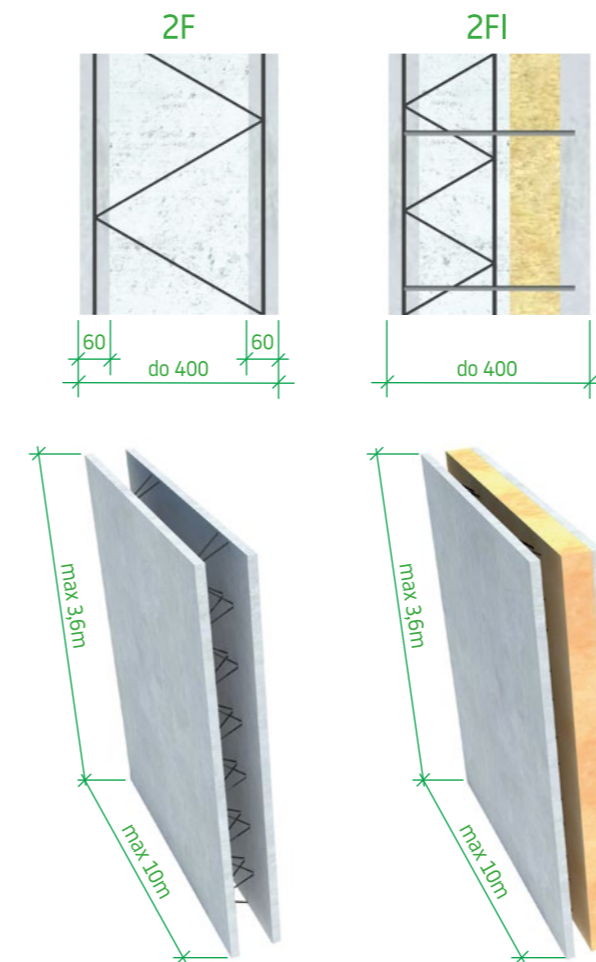

TWIN WALLS

Advantages of twin walls:

- less time spent on erection works as planking and wall reinforcement are not necessary (load bearing function combined with stay-in-place formwork)
- high quality of surface elements – no need of plastering
- quick and easy installation
- lightweight panels
- high sound proofing
- prefabricated yet monolithic wall (rigid nodes)
- door, window and installation openings can be placed in many ways
- pre-installed electrical conduits for easy pulling of electrical cabling
- any accessory items can be embedded as required by the client
- thermal insulation can be factory installed in the wall – 2FI model
- on-time completion, irrespective of weather conditions, precision
- reduction of site facilities – just-in-time delivery

Other applications

- excavation sidewalls
- retaining walls
- bunkers
- construction abutting existing buildings

